

\$8 - 4628 62 Street, Red Deer

MLS® #A2216425

\$8

0 Bedroom, 0.00 Bathroom,
Commercial on 0.00 Acres

Riverside Light Industrial Park, Red Deer,
Alberta

Located in Riverside Light Industrial Park, this space offers 11,206 SF with a reception area/lobby, six offices (some with windows), two meeting rooms/boardrooms, a file room, multiple storage rooms, and two washrooms. The large shop has 20' ceilings and is separated into two areas with (5) 14' overhead doors. The yard is fenced and graveled with paved parking available directly in front. Additional Rent is \$4.06 for the 2025 budget year.

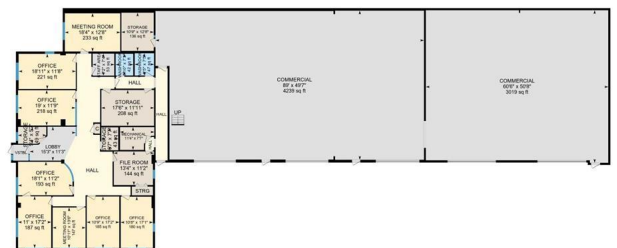

Built in 1992

Essential Information

| | |
|------------|------------|
| MLS® # | A2216425 |
| Price | \$8 |
| Bathrooms | 0.00 |
| Acres | 0.00 |
| Year Built | 1992 |
| Type | Commercial |
| Sub-Type | Industrial |
| Status | Active |



Community Information

| | |
|-------------|---------------------------------|
| Address | 4628 62 Street |
| Subdivision | Riverside Light Industrial Park |
| City | Red Deer |
| County | Red Deer |
| Province | Alberta |

Postal Code T4N 6T3

Additional Information

Date Listed May 1st, 2025
Days on Market 123
Zoning I1

Listing Details

Listing Office RE/MAX Commercial Properties

Data is supplied by Pillar 9â„¢ MLS® System. Pillar 9â„¢ is the owner of the copyright in its MLS® System. Data is deemed reliable but is not guaranteed accurate by Pillar 9â„¢. The trademarks MLS®, Multiple Listing Service® and the associated logos are owned by The Canadian Real Estate Association (CREA) and identify the quality of services provided by real estate professionals who are members of CREA. Used under license.